

# 65 TON BOLLARD PULL BERTHING TUG



## General

Yard No. : 153  
Delivery Date : 05.04.2001  
Basic Functions : Towing & Berthing of Ships  
Classification : LR + 100 A1+LMC  
Harbour Tug  
(Sri Lanka Coastal Waters)

## Dimensions

Length Overall : 34.47 M  
Length at water level : 31.43 M  
Beam Mld. : 12.10 M  
Depth : 6.90 M  
Draught Max. : 4.40 M  
Gross Tonnage : 553 Tons

## Performance

Bollard Pull  
Ahead Bollard Pull : In excess of 65 Tons  
Astern Bollard Pull : In excess of 50 Tons

Speed : 13 Knots  
Endurance : 1500 Nm

## Fire Fighting Capabilities

External Fire Pump : Counterfire BOB 150-50 Pump

## Tank Capacities

Fuel Oil : 120 MT  
Fresh Water : 50 MT

## Main Propulsion Machinery

Main Engines : 2 x WARTSILA 8 L 26  
Propulsion : Aquamaster Kamewa Azimuth  
US 3001 CP Thrusters

## Auxiliary Machinery

Main Generators : 2 x YANMAR 6 HAL 2- HTN  
Harbour Generators : 1 x YANMAR 6 CHL- HTN

## Deck Machinery

Anchor Windlass : JADEN  
Towing Hook : MAMPAEY  
Capstan : JADEN

## Accommodation

Officers : 2 Officers  
Crew : 16 Men

## Navigation Equipment

Radar : FURUNO 1942- MK2  
Echo Sounder : FURUNO FCV- 581 L  
EPIRB : MCMURDO 406  
Magnetic Compass : TOKIMEC SH 165 A  
GPS : FURUNO GP - 80  
SART : SART - 9 GHZ

## Communication Equipment

VHF Radio Telephone : FURUNO FM 8500/DSC  
Public Address System : Furuno PA - 505 TK  
Intercom : JRC 11 Branch  
SSB : Furuno FS 1562 - 15

## Owner

Sri Lanka Ports Authority

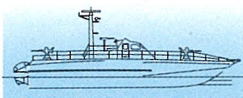

**Colombo Dockyard Limited**

Ship Builders, Repairers & Heavy Engineers



Port of Colombo, Sri Lanka. Tel. +94 11 2522461-5, Fax. +94 11 2471335/ 2446441

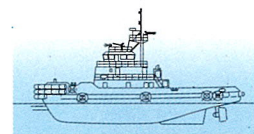

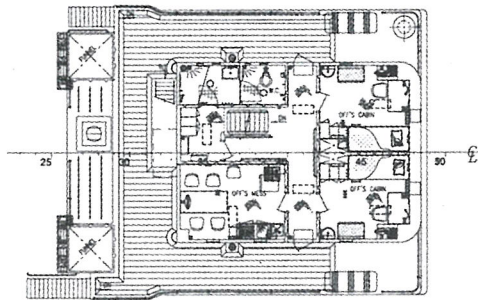

**UPPER DECK**

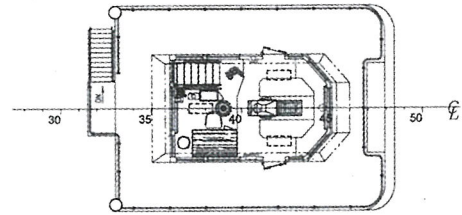

**NAVI. BRIDGE DECK**

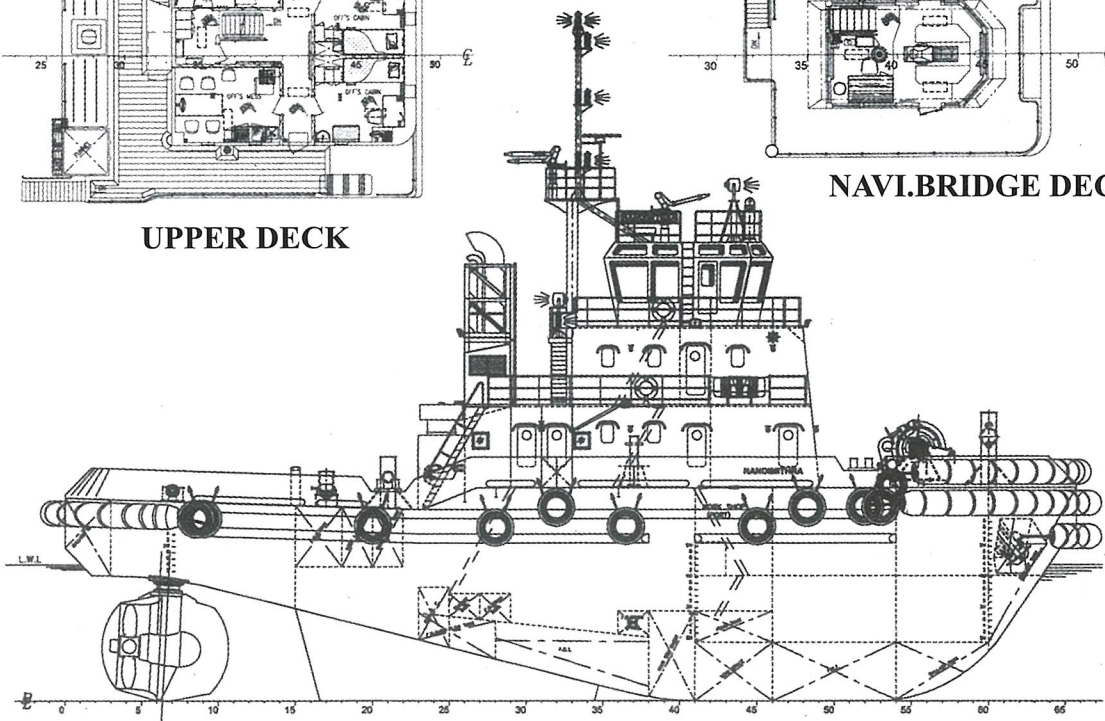

**PROFILE**

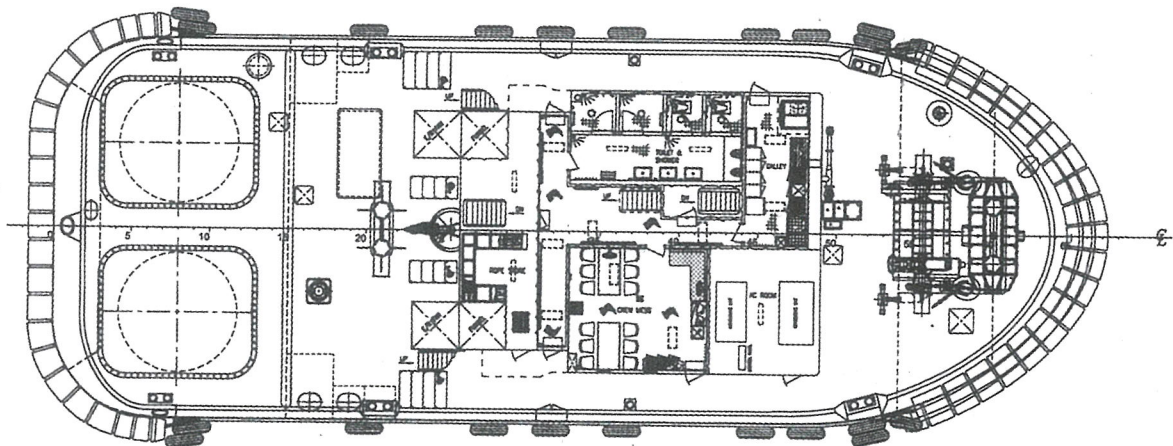

**MAIN DECK**

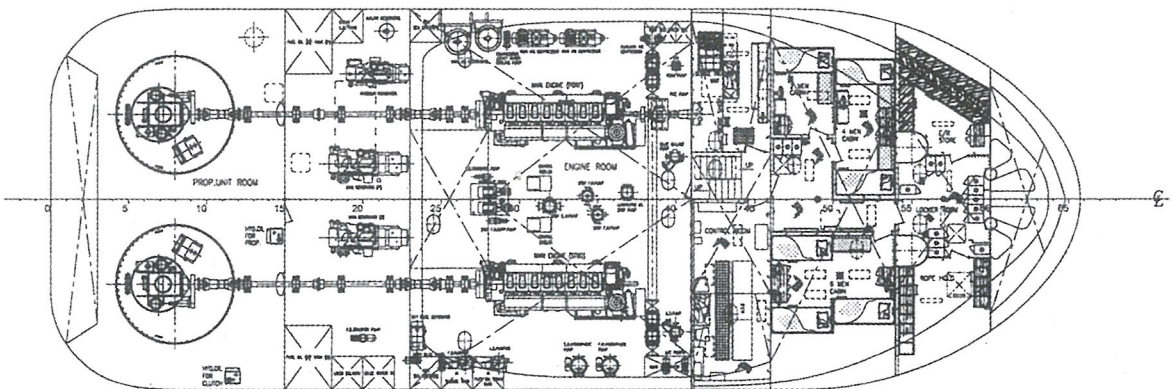

**UNDER DECK**